

Breitenbach Archipelago

/ˌɑːr.kəˈpel.ə.ɡoʊ /, noun <fig.>:
separate entities forming a whole

Breitenbach Archipelago deals with an urban context both demanding and promising. The project site is currently characterized by confusing and uninviting open spaces lacking vividness, walkability, and diversity of users. A void will be left after the removal of the bridge. At the same time, it will make publicly owned land available to new uses.

Breitenbach Archipelago aims at reconciling the two historical contours that have shaped the area, the oval of the square and the elongated curve of the highway bridge. It recognizes the heterogeneous nature of the project site as an asset allowing for the creation of a vibrant and diverse quarter.

ANALYSIS

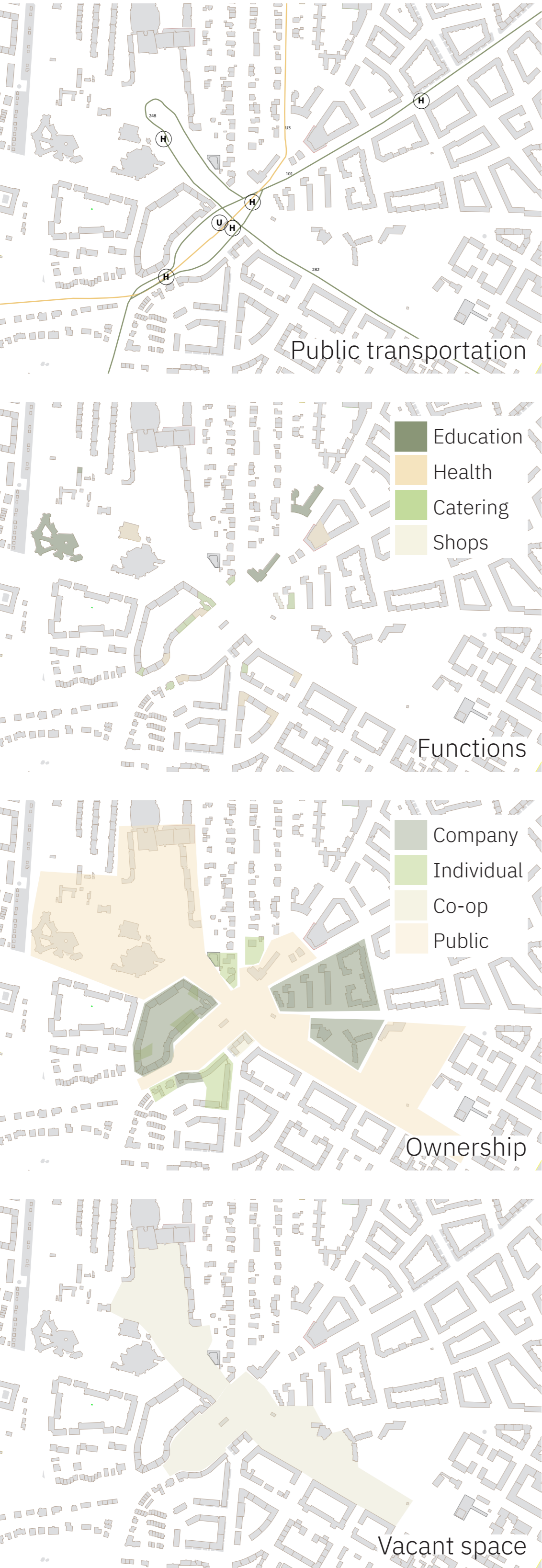

CONCEPT

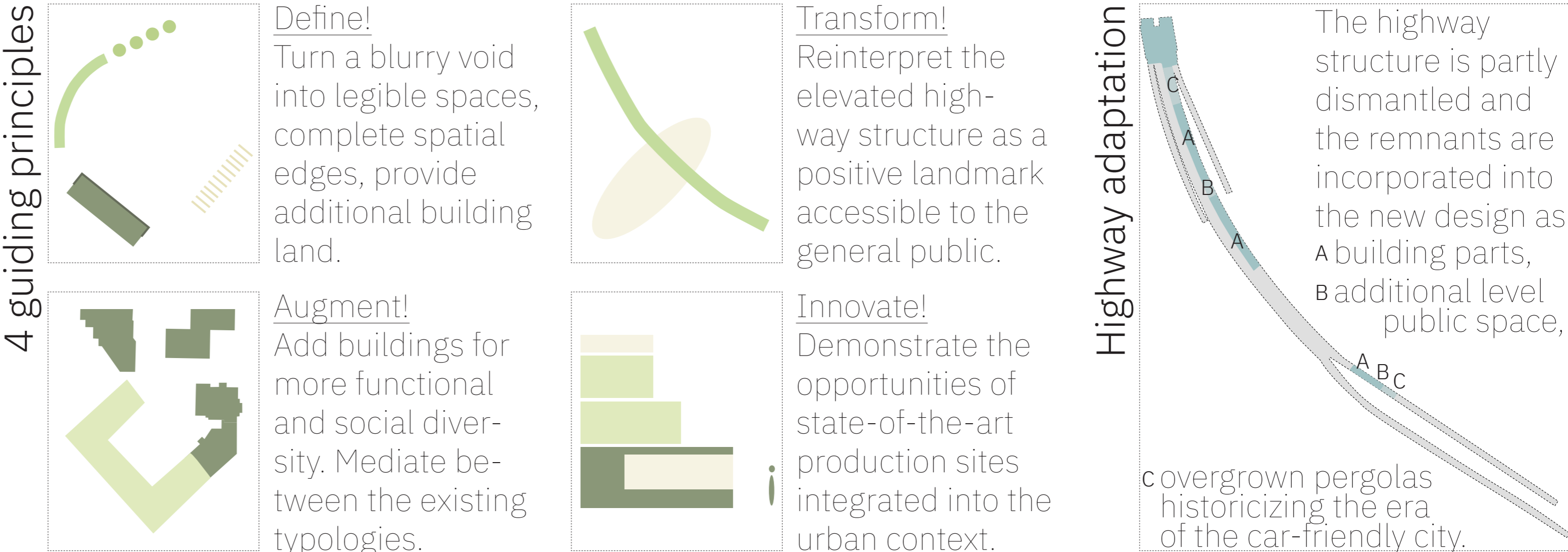

The Productive Cluster adjoins the obsolete Schlange tunnel tubes turned into a food production site. Welcoming interested visitors, it will be a showcase of urban manufacturing.

The Core Cluster includes four distinct squares attracting various user groups. Important existing buildings like the Institute of Latin American Studies, the pavilion of the artist colony or the St. Petrus church are complemented with new buildings for sociocultural facilities, services, office and residential use.

The Residential Cluster expands the established function with additional buildings. A variety of floor plans allows for multigenerational, inclusive, and other communal forms of housing. Spacious green courtyards contribute to a high quality of living.

Breitenbach Archipelago

Four distinct squares = the basis of the eponymous archipelago of public spaces.

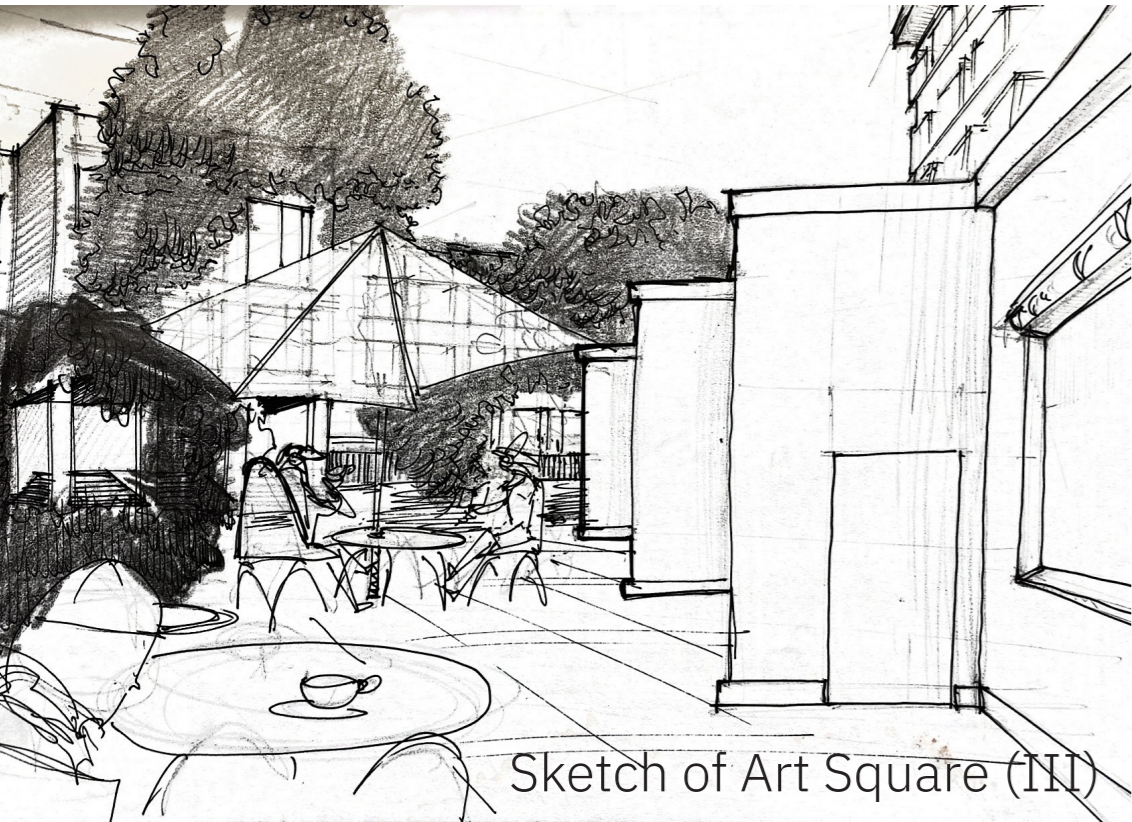

One of the streets encircling the green square is closed to traffic, offering additional space for outdoor dining and a weekly farmers' market. The remaining streets in the core cluster are turned into a shared space to slow down traffic and improve the conditions for active mobility. Equipped with a special surface, this shared space also visually connects the individual parts of the archipelago.

